

ORDERING INFORMATION

Input Voltage	Output 1 Voltage	Output 2 Voltage	Maximum Power	Model Number
9-36V	3.3V @ 2.42A		8W	AA10B-012L-033S
9-36V	5V @ 2A		10W	AA10B-012L-050S
9-36V	12V @ 0.830A		10W	AA10B-012L-120S
9-36V	15V @ 0.670A		10W	AA10B-012L-150S
9-36V	5V @ 0.750A	-5V @ 0.750A	7.5	AA10B-012L-050D
9-36V	12V @ 0.375A	-12V @ 0.375A	9W	AA10B-012L-120D
9-36V	15V @ 0.300A	-15V @ 0.300A	9W	AA10B-012L-150D
<hr/>				
18-75V	3.3V @ 2.42A		8W	AA10B-046L-033S
18-75V	5V @ 2A		10W	AA10B-046L-050S
18-75V	12V @ 0.830A		10W	AA10B-046L-120S
18-75V	15V @ 0.670A		10W	AA10B-046L-150S
18-75V	5V @ 0.750A	-5V @ 0.750A	7.5W	AA10B-046L-050D
18-75V	12V @ 0.375A	-12V @ 0.375A	9W	AA10B-046L-120D
18-75V	15V @ 0.300A	-15V @ 0.300A	9W	AA10B-046L-150D
<hr/>				
36-75V	1.5V @ 3A		4.5W	AA10B-048L-015S
36-75V	2.1V @ 3A		6W	AA10B-048L-021S
36-75V	3.3V @ 2.42A		8W	AA10B-048L-033S
36-75V	5V @ 2A		10W	AA10B-048L-050S
36-75V	12V @ 0.830A		10W	AA10B-048L-120S
36-75V	15V @ 0.670A		10W	AA10B-048L-150S
36-75V	5V @ 0.750A	-5V @ 0.750A	7.5W	AA10B-048L-050D
36-75V	12V @ 0.375A	-12V @ 0.375A	9W	AA10B-048L-120D
36-75V	15V @ 0.300A	-15V @ 0.300A	9W	AA10B-048L-150D

NEW

*For remote enable option, add suffix "E" to the part number. For example: AA10B-048L-050SE= 48V in, 5V out with remote enable. Please contact Astec for information on other output voltages, power ranges and configurations.

DIMENSIONS

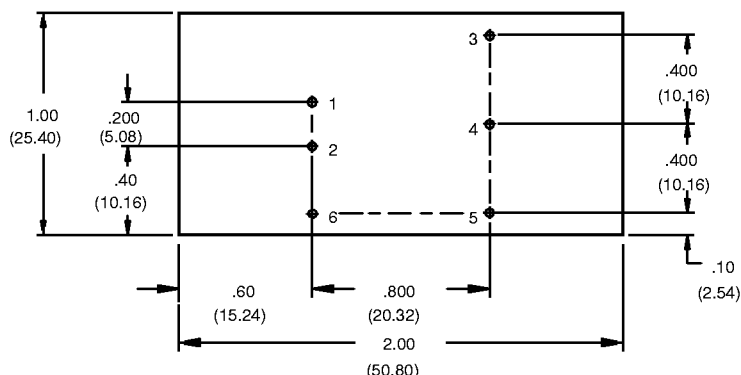

BOTTOM VIEW

ALL DIMENSIONS ARE IN INCHES (mm)

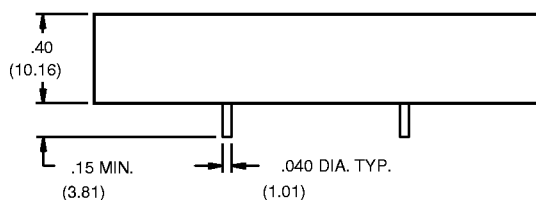

Case Material: Metal
 Weight: 1.4 oz/40 grams

PIN ASSIGNMENTS

Single Output

1. +Vin (Case GND -48/-46 models)
2. -Vin (Case GND -12 models)
3. Output 1
4. No pin
5. COMM
6. Enable (E models only)

Dual Output

1. +Vin (Case GND -48/-46 models)
2. -Vin (Case GND -12 models)
3. Output 1
4. Common
5. Output 2
6. Enable (E models only)

NOTES

1. 20 MHz bandwidth. An external 0.1 uf ceramic capacitor is recommended to be placed from +V out to comm.
2. Meets EN55022 Class A (-150S/D require 2.2uf input capacitor). Consult factory for filter recommendations to meet FCC class B, VDE or EIC specifications.
3. All specifications are typical at nominal line, full load, and 25°C unless otherwise noted.
4. All specifications subject to change without notice.
5. Mechanical drawings are for reference only.
6. Calculated per MIL HDBK 217F, Ground benign at 25°C, full load. BELLCORE calculated per TR-NWT-000332 method 1 parts count, Case 1.